

# COUNTY HALL CAMPUS CAR PARKS Proposed Changes

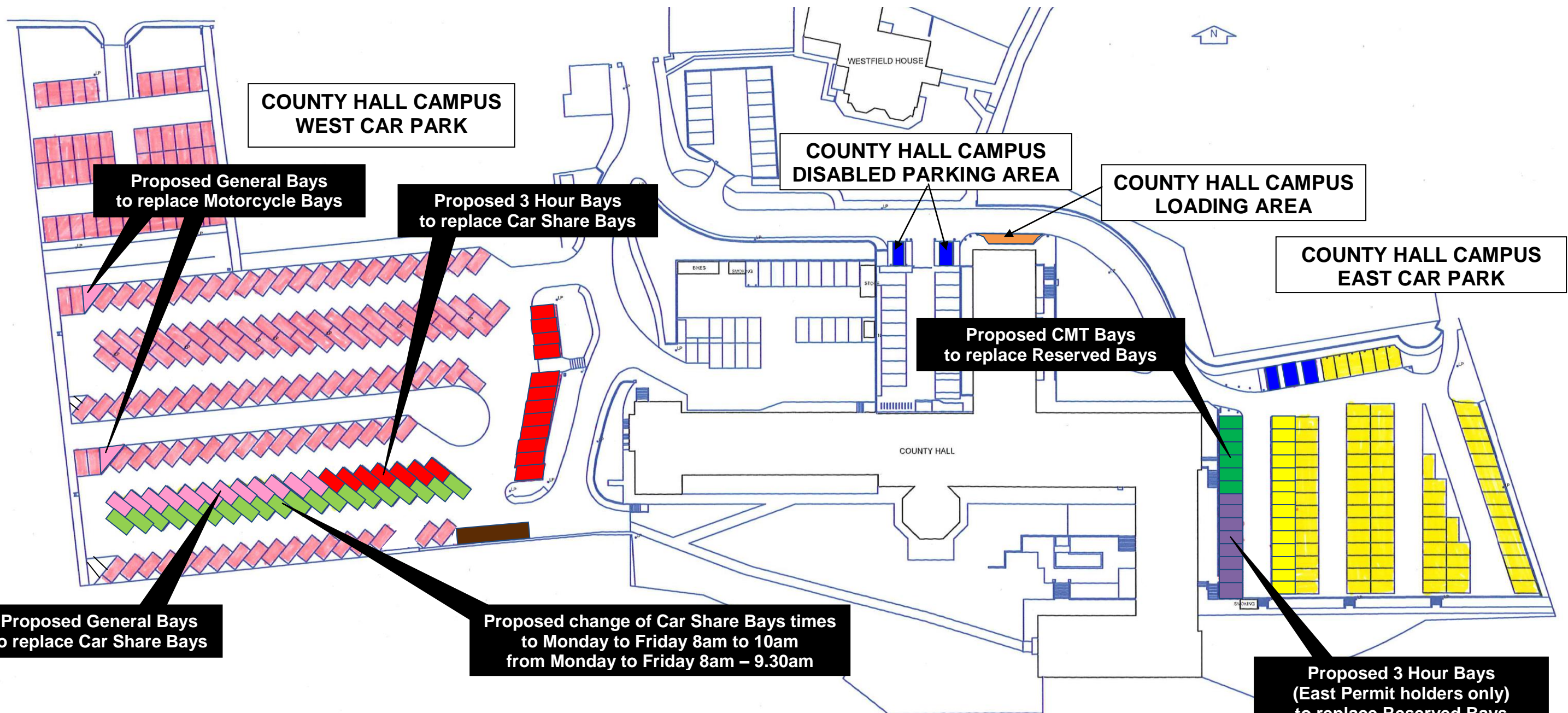

### WEST CAMPUS CAR PARK

- General Bay**  
Monday to Friday 8am – 5pm  
West or East Permit holder or Public parking bays  
**Saturday 8am – 5pm** Public parking bay
- 3 Hour Bay**  
Monday to Friday 8am – 5pm  
West or East Permit holder or Public parking bay  
Maximum stay of 3 hours, No return within 2 hours  
**Saturday 8am – 5pm**  
Public parking bay
- Car Share Bay**  
Monday – Friday 8am – 10am  
West or East Permit holder plus at least 2 permit holders registered as using bay  
As **General Bay** at other times

### KEY TO BAY TYPES

- Bus Bay**  
East Sussex County Council liveried buses only
- LOADING AREA**  
Loading/ unloading only  
maximum stay of 15 minutes  
no return within 1 hour
- DISABLED PARKING AREA**  
Blue Badge Holder only bay

### EAST CAMPUS CAR PARK

- General Bay**  
Monday to Friday 8am – 5pm  
East Permit holders only  
**Saturday 8am – 5pm**  
Public parking bay
- 3 Hour Bay**  
Monday to Friday 8am – 5pm  
East Permit holder bay  
Maximum stay of 3 hours, No return within 2 hours  
**Saturday 8am – 5pm**  
Public parking bay
- Blue Badge Bay**  
Blue Badge Holder only bay
- CMT Bay**  
CMT Permit Holders only at all times

Drawing No. CHCP001

03/10/2017